

The Hampshire Stand Ground Floor

NOT TO SCALE

MAIN DOORS, END DOORS, FRONT DOORS

W-1.50m H-2.042m

CHAMPAGNE BAR DOORS

W-1.47m H-2.11m

WALK THROUGH TO WINE CELLAR

W-1.77m H-2.08m

LIFT DOORS

W-1.07m H-1.99m

LIFT INTERNAL

W-1.51m H-2.19m D-1.13m

LIFT CAPACITY



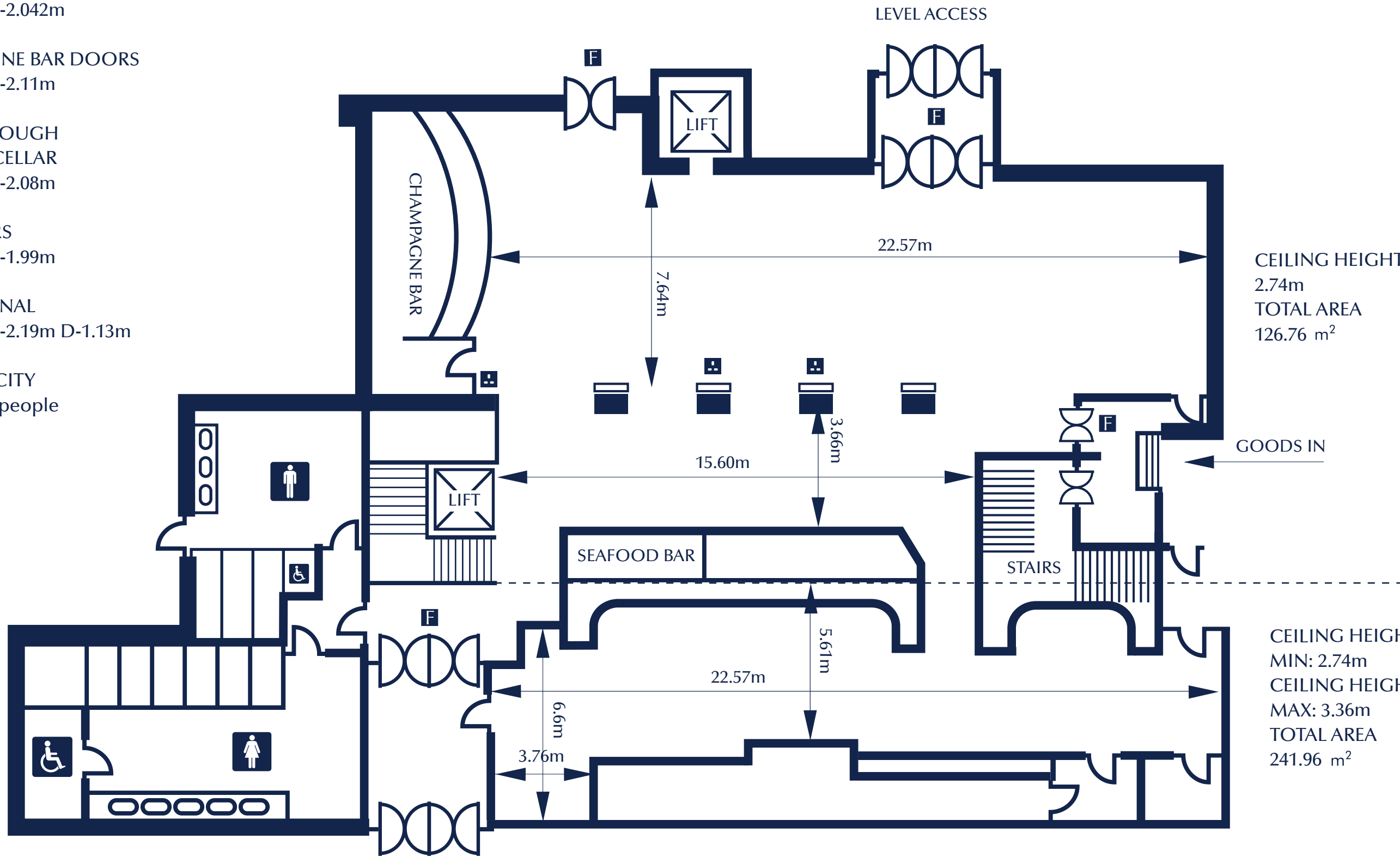

1000kg, 13 people



CEILING HEIGHT:
2.74m
TOTAL AREA
126.76 m²

CEILING HEIGHT
MIN: 2.74m
CEILING HEIGHT
MAX: 3.36m
TOTAL AREA
241.96 m²

KEY

-  Power Points
-  Toilets
-  3 Phase Power 63 or 32 Amp
-  VDU
-  Fire Doors

RACECOURSE